

RANGE

Expansion joint centrally placed- Verni-Supagaurd Waterstop centre bulb

Centre bulb sections are used in expansion, contraction and construction joints. The centre bulb allows for movements in a structure to be accommodated.

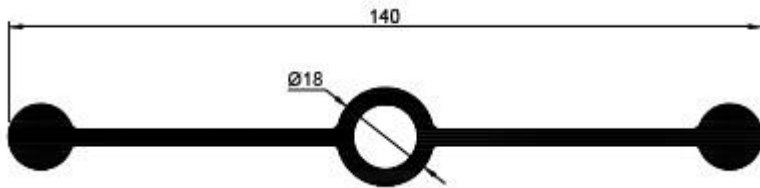

61 0712 301

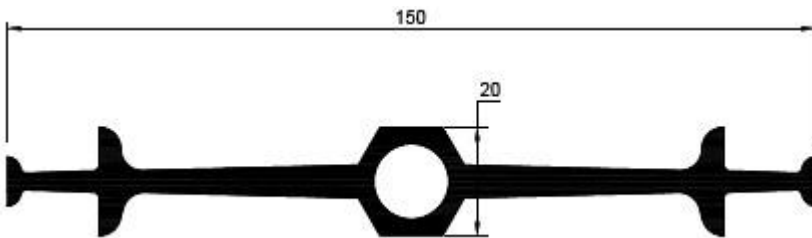

61 1647 301

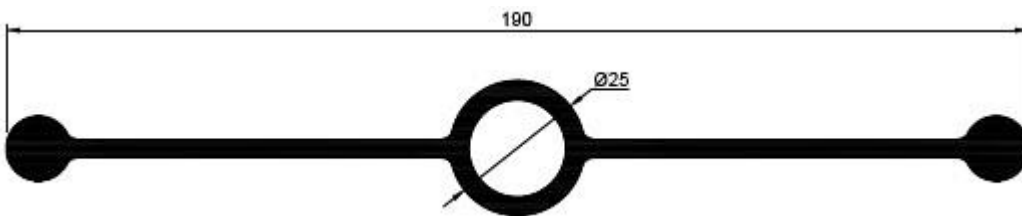

61 0715 301

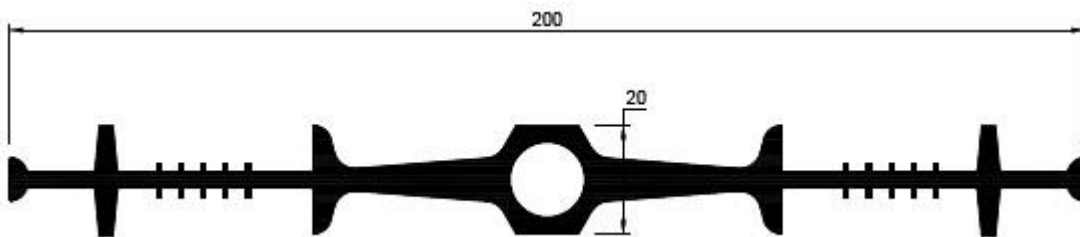

61 1643 301

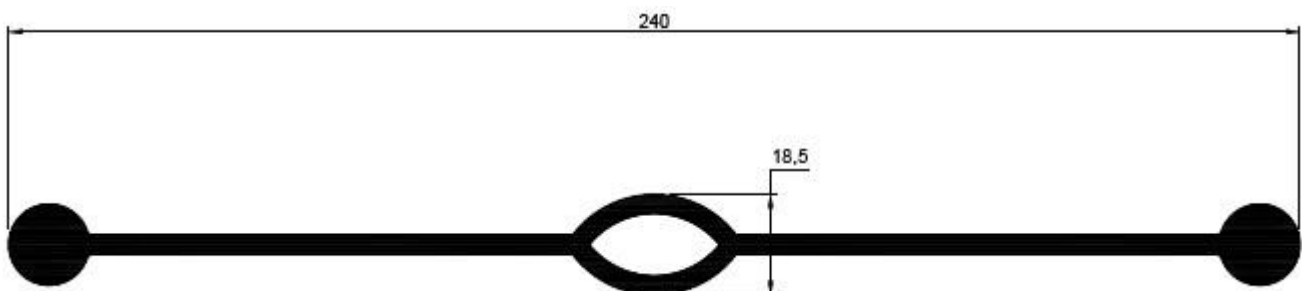

61 0739 301

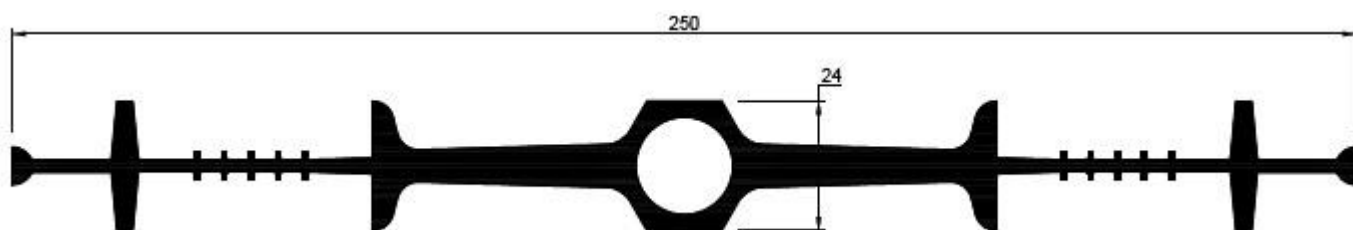

61 1639 301

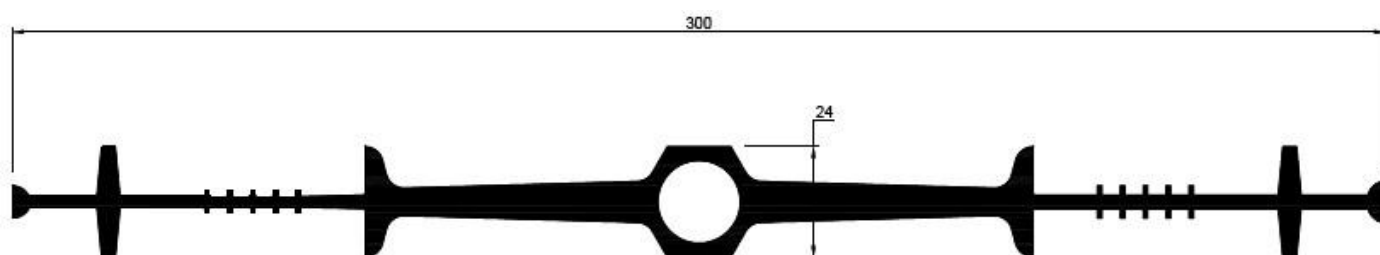

61 2393 301

Construction joint centrally placed- Verni-Supagaurd Waterstop dumbbell (Ball)

Plain web sections are used in construction and contraction joints.

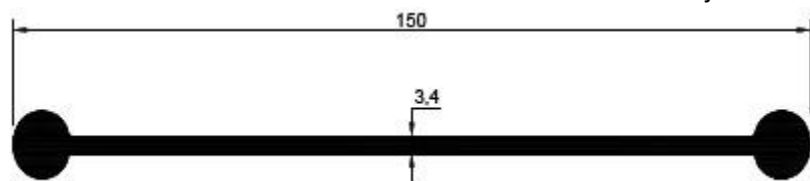

61 0711 301

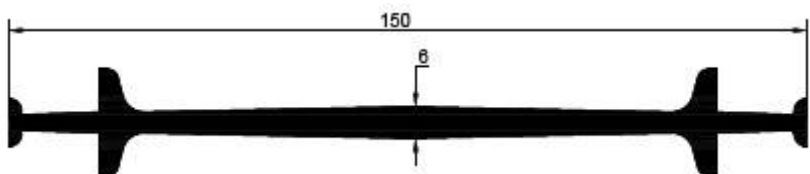

61 1648 301

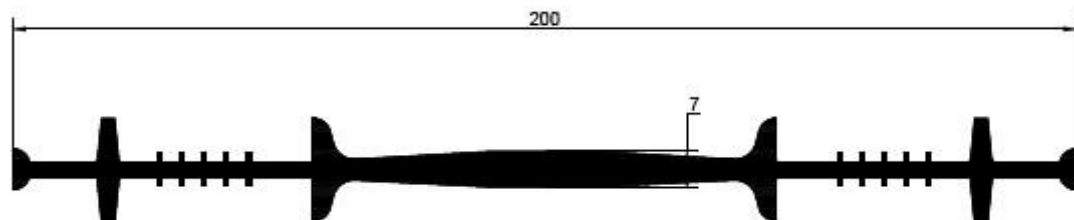

61 1644 301

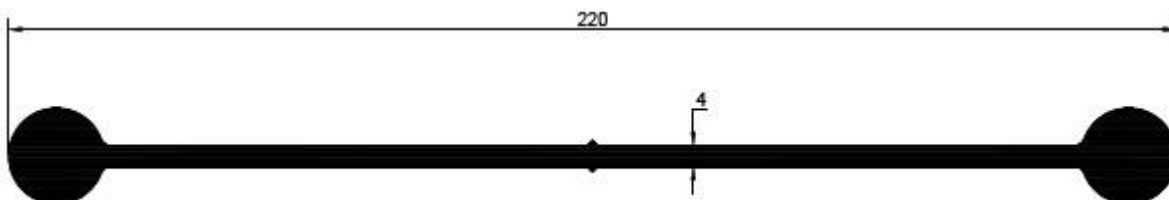



61 1614 301

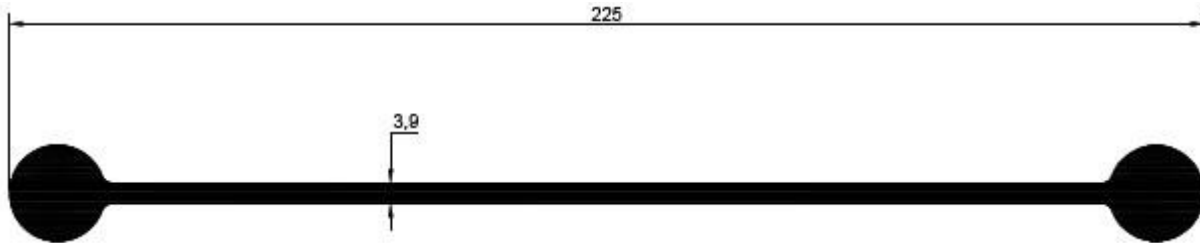

61 0714 301

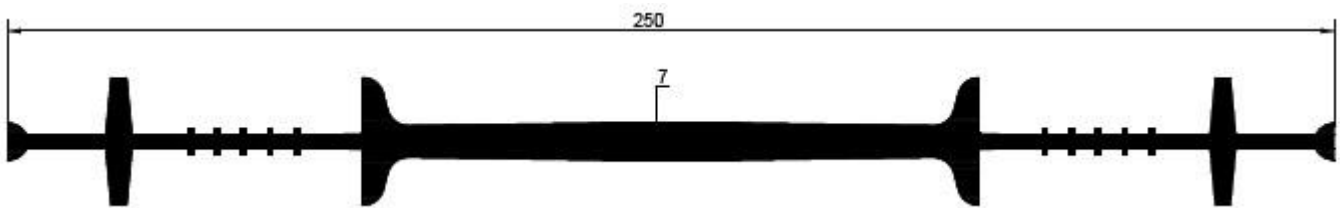

61 1640 301

Expansion joint externally placed - Verni-Supagaard Waterstop external E (Square) and Verni-Supagaard Waterstop external E (Dove)

Incorporating a flat top center box, which allows movement to be accommodated in expansion joints. The box also provides a seating to support joint fillers

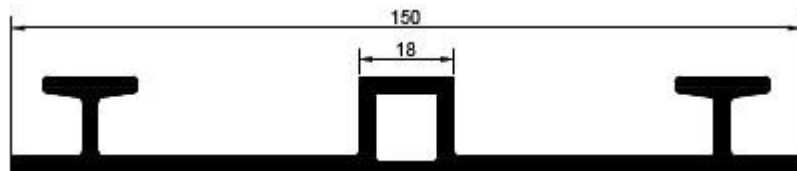

61 1872 301

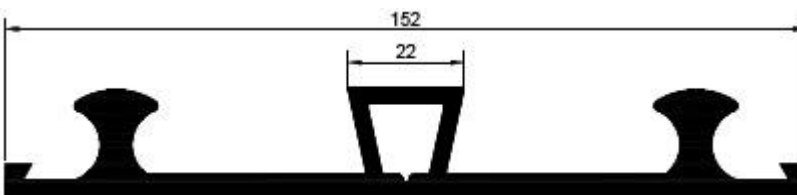

61 1645 301

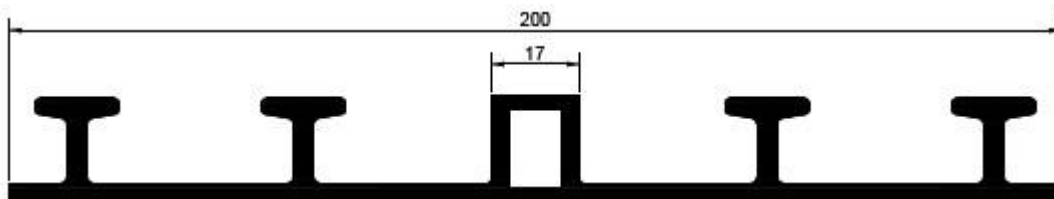

61 0866 301

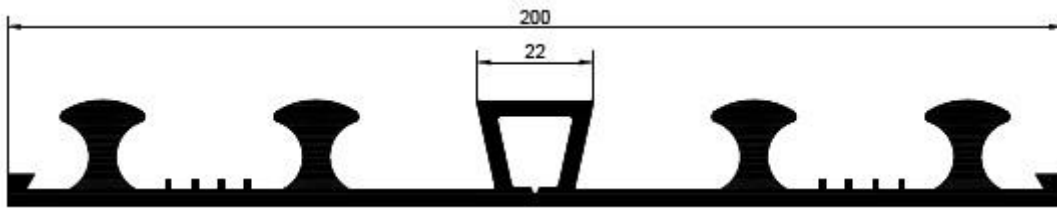

61 1641 301

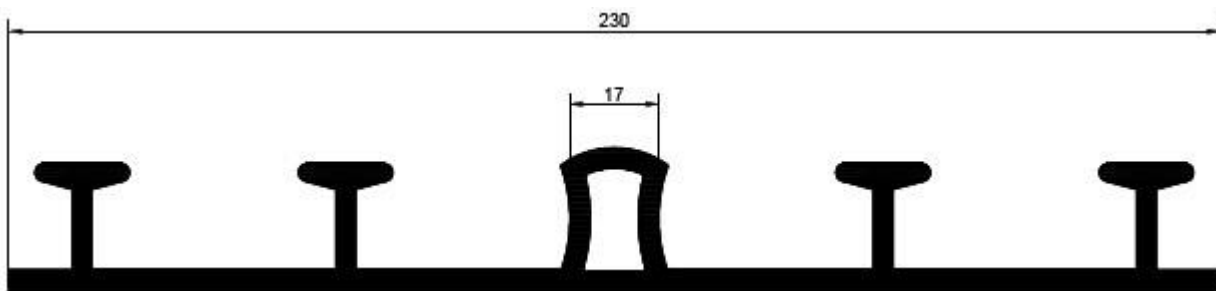

61 1701 301

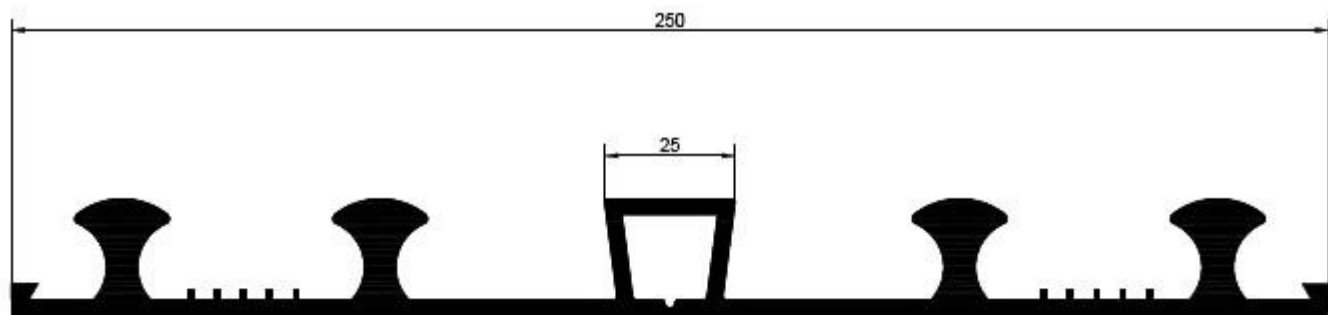

61 1637 301

Construction joint externally placed- Verni-Supagaurd Waterstop external C

Incorporating a central fin to assist setting out shutter location

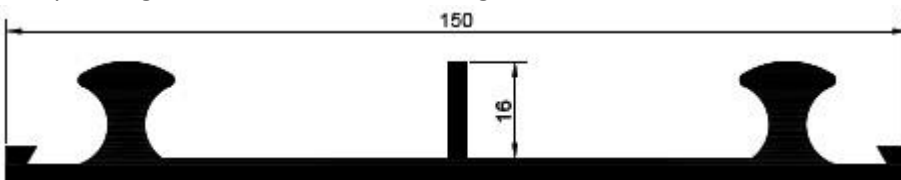

61 1646 301

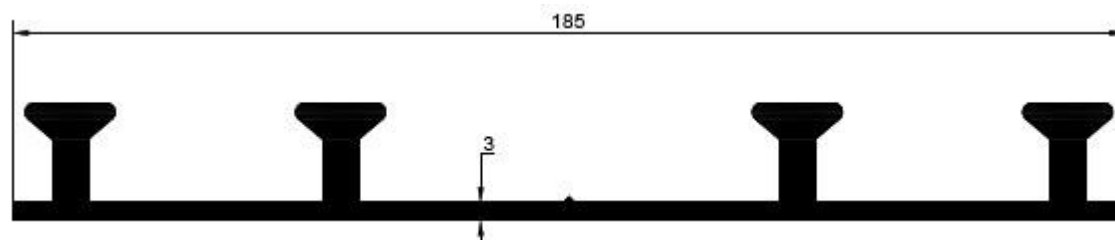

61 1618 301

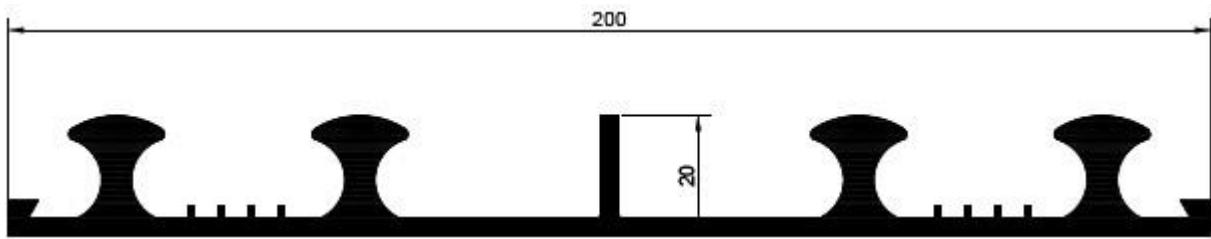

61 1642 301

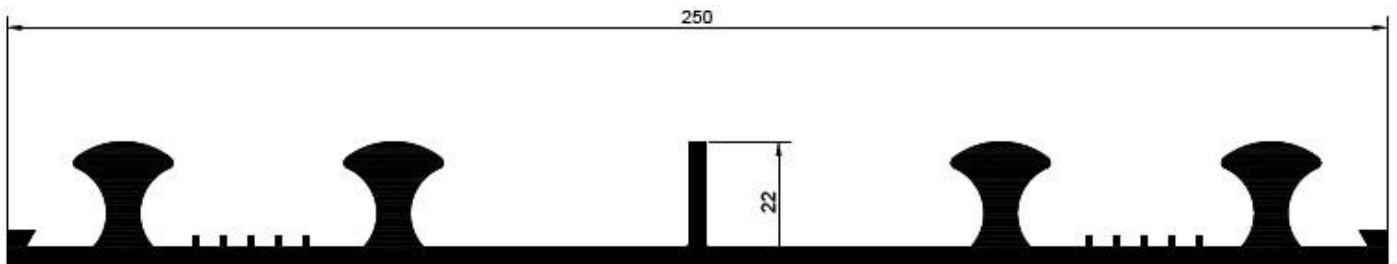

61 1638 301

Construction joint externally placed - Verni-Supagaard Waterstop external X

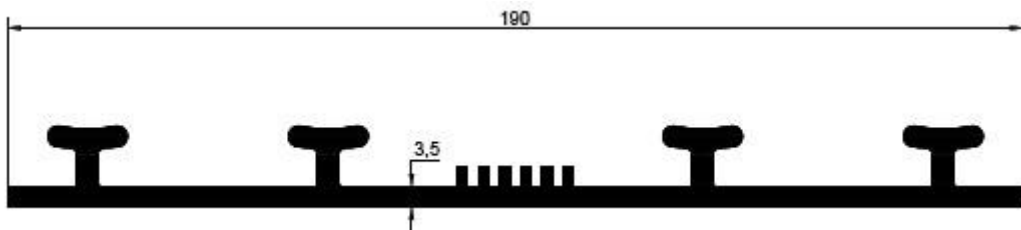

61 1703 301

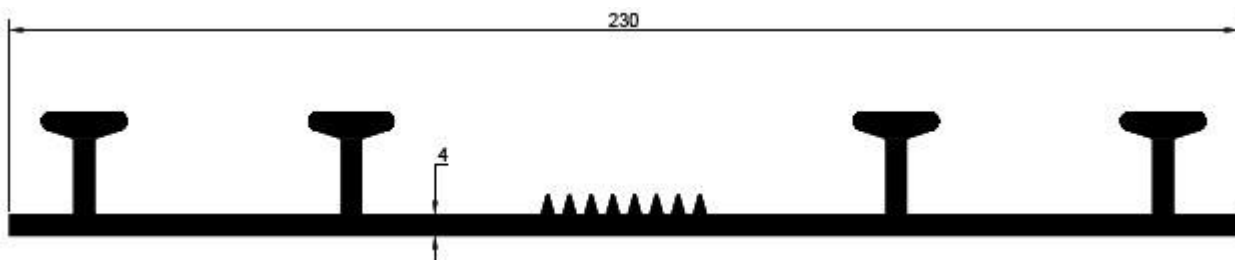

61 1702 301